

Specification.

Hot Water Supply: Recommended: 60-65C

Operating Pressure: Min: 0.1bar – Max: 5bar
Recommended: 0.3 – 5bar

IMPORTANT:

A 10C DIFFERENCE MUST BE MAINTAINED BETWEEN SYSTEM HOT WATER TEMPERATURE AND THE MIXERS MAXIMUM HOT WATER TEMPERATURE.

Hot and Cold water pressures supplying this mixer must be balanced and from a common source.

Should the water pressure be higher than 5bar fit a pressure reducing valve before the mixer. (Not supplied).

Aftercare Instructions.

Whilst modern plating techniques have been used in the finishing of this product the surfaces will suffer if not cleaned correctly.

Clean this product with a soft cloth and clean water.

The product must not be cleaned or come into contact with any abrasive agents or materials.

If this occurs the guarantee will be invalid.

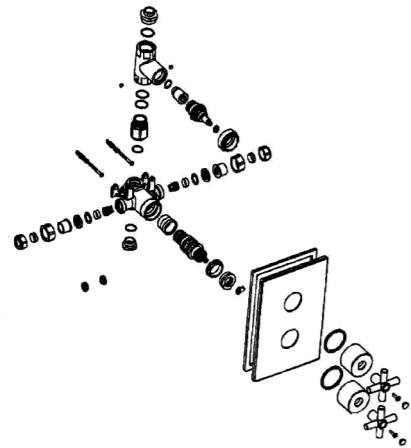

HIGH PRESSURE SYSTEMS.

This mixer is suitable for high and low pressure systems.

When being installed to high pressure supplies, water flow regulators may be used (supplied) in order to reduce water consumption.

These are recommended for use with pressures over 1bar.

These are fitted into the Mixers inlets as follows:

1. Remove the connector assembly, which will expose the filter washer, connector ring and spacer ring.
2. Remove all the above then the flow restrictor should be fitted into the mixer inlet. Push the flow reducer into the inlet until it stops.
3. Re-fit the connector using the components shown in the picture below (DO NOT RE-FIT THE SPACER RING) and re-connect the connector assembly to the mixer inlet.

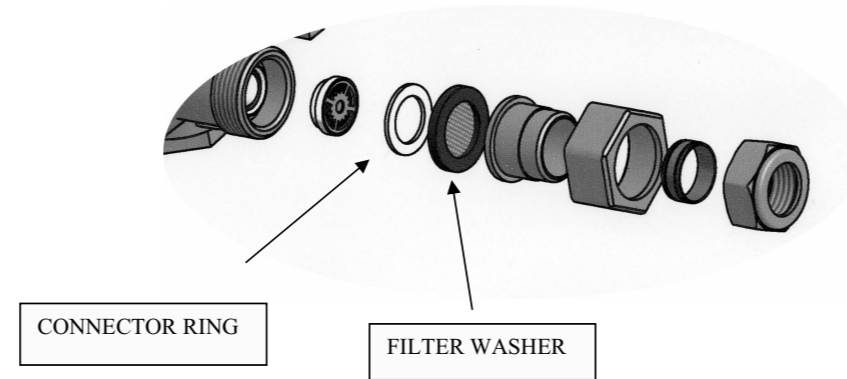

Guarantee.

You will need to provide proof of purchase in the event of a claim.

The product is guaranteed against faulty materials and manufacture for a period of one year from the date of purchase.

The guarantee does not include faults or damage caused by the following:

- Wear and tear of normal use.
- Incorrect installation.
- Water quality
- Improper operation, tampering, incorrect maintenance.
- Internal problems caused by particles and debris.
- Freezing, ice.
- The use of improper cleaning materials.

This product is for domestic use only.

The guarantee in no way affects the statutory rights of the consumer.

TECHNICAL HELPLINE. 01959 560760

Gainsborough Bathroom Products Ltd.

Customer Services Department

The Flyers Way

Westerham, TN16 1DE.

www.gainsboroughshowers.co.uk

Dual Control Concealed Thermostatic Shower Mixer With Shower Kit Installation & Maintenance Instructions. **Gainsborough GS700**

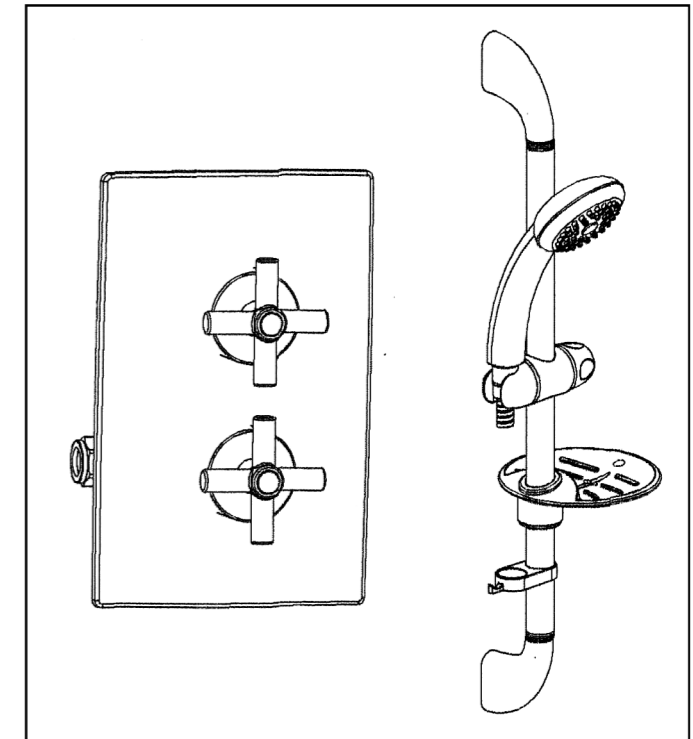

IMPORTANT

This product must be fitted in accordance with the latest Water Regulations Guide which include the Water By Laws 2000 (Scotland)

Please retain this instruction leaflet for future reference to ensure optimum shower valve performance.

Installation.

This product must be fitted in accordance with the Water Byelaw Regulations. **IMPORTANT.** Flush pipework prior to fitting the mixer. Do not allow dirt or metal particles to block the water inlets, once the pipes have been flushed, turn off the water.

We recommend the fitting of Full Flow ball type isolation valves to assist should any maintenance work be required.

FITTING

1. Install the pipework up to the shower area and ensure that it has been flushed.
2. Ensure that the hot supply is to the left of the mixer, marked H on the mixer body when looking at the mixer from the front. The outlet to the shower is above.
3. Prepare the hole into which the mixer will be fitted. See **TECHNICAL DRAWINGS for the Cavity Depth.**
4. Mark the position for the screw holes, drill the holes, push in the plugs and screw the mixer to the wall.
5. Connect all pipe work and test for leaks.
6. Make good the concealing hole.
7. Turn off the water.
8. If the handles are fitted to the mixer remove them by taking off the handle cover caps, removing the screws and pulling off the handles.
9. Remove the valve cover shrouds.
10. Place the wall plate over the valve and hold it in place by re-fitting the valve cover shrouds.
11. Replace the handles, handle screws and cover caps.

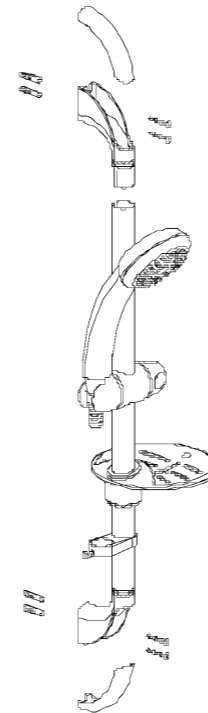
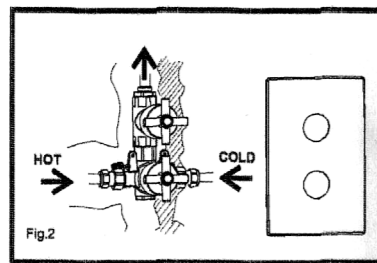
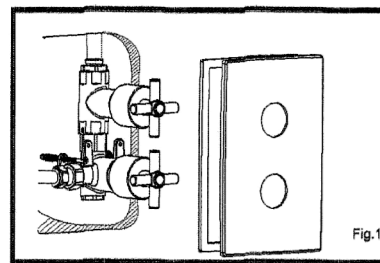

SHOWER KIT INSTALLATION

Position brackets in the desired position and mark drill hole, suitable for the intended wall plugs. Once wall plugs have been inserted connect rail to the fixing brackets and secure using the screws provided. Replace the clip-on bracket covers to complete the installation.

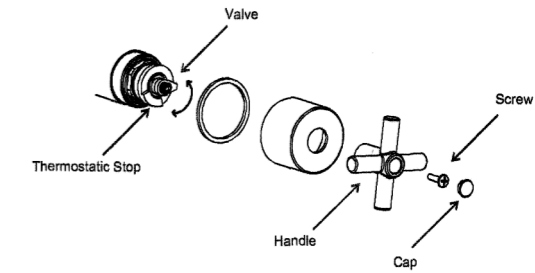
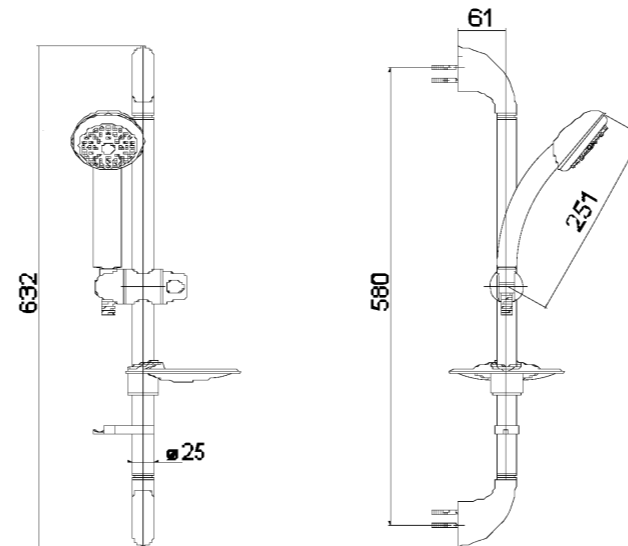

Hot Water Supply.

This mixer is suitable for any water heating system

In the case of Combination Boilers, the appliance must have a minimum domestic hot water rating of 24kW (80,000BTU) and be of the type fitted with a fully modulating gas valve.

If in any doubt, please contact the appliance manufacturer before installation commences.

PLEASE NOTE: DUE TO PERFORMANCE CHARACTERISTICS OF COMBINATION BOILERS, THE SHOWER FLOW RATE MAY VARY WITH CHANGES TO THE COLD WATER MAINS INLET TEMPERATURE.

Technical Drawing.

